

Double or single engagement brake drum and disc brake couplings are used for applications such as cranes, hoists and conveyors. Brake drum and disc brake couplings accommodate misalignment between connected equipment and eliminate the need for double shaft extensions on motors and gear drives for applications requiring brakes.

SERIES ZZB I SIZE 10 - 45

with Brake Drum

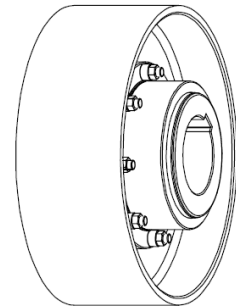
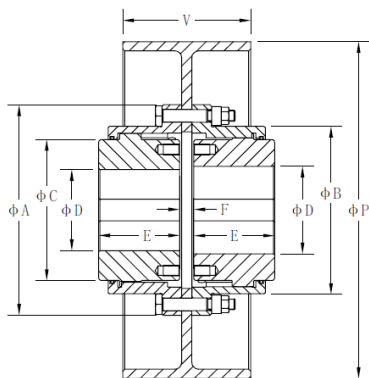

Size	TN Nm (1)	TP Nm	n Max rpm(2)	A	B	C	D Max (3)	E	F	P	V	Weight Max Kg (4)	Weight Min Kg (5)	Inertia J Kgm2 (4)
10	1,800	3,600	2850	111	82.5	69	52	43	13	200	75	9	8	0.045
			1800					13	200	75	13	11	0.056	
15	2,760	5,520	2300	141	104.5	85	62	50	13	250	95	17	14	0.119
			1800					15	315	118	24	22	0.326	
			2300					13	250	95	23	19	0.144	
20	5,550	11,100	1800	171	127.5	107	78	62	15	315	118	31	26	0.351
			1650					15	350	130	35	30	0.519	
			1450					19	400	150	50	45	1.112	
			1800					17	315	118	42	33	0.411	
25	8,700	17,400	1650	210	156	133	98	76	19	350	130	47	39	0.604
			1450					19	400	150	60	51	1.152	
			1800					19	315	118	54	41	0.500	
30	14,100	28,200	1650	234	181.5	152	112	90	19	350	130	60	47	0.700
			1450					19	400	150	72	59	1.240	
			1800					17	315	118	54	41	0.500	

			1300						19	450	170	79	66	1.770
35	22,800	45,600	1450	274	210.5	178	132	105	20	400	150	90	73	1.480
			1300						20	450	170	97	80	2.01
			1150						20	500	190	107	90	2.88
40	34,800	69,600	1150	312	248.5	209	156	120	21	500	190	142	112	3.37
			1100						21	530	195	150	120	4.10
			1000						24	630	236	192	163	8.68
45	44,000	88,000	1150	337	274	234	174	135	23	500	190	168	130	3.85
			1100						23	530	195	176	138	4.58
			1000						26	630	236	218	180	9.16
			800						26	710	265	247	208	14.07

✓ From size 45 (included) the coupling is supplied by default with puller holes. If required, puller holes can also be made for smaller sizes.

✓ Setscrews can be included upon request.

✓ Adapted hub length and value F available upon request.

(1) The torque of the coupling does not include the connection transmission capacity.

(2) Maximum speed calculated according to standard brake material (EN-GJL-250) n MAX speed for balanced couplings. For higher speeds contact Feinnord.

(3) Max. allowable bore for couplings with DIN 6885/1 key. For other types of keys or connections please contact Feinnord.

(4) Weight and moment of inertia are given for minimum bore.

(5) Weight is given for maximum bore.