

Double or single engagement brake drum and disc brake couplings are used for applications such as cranes, hoists and conveyors. Brake drum and disc brake couplings accommodate misalignment between connected equipment and eliminate the need for double shaft extensions on motors and gear drives for applications requiring brakes.

## SERIES ZSB I SIZE 10 - 45

### With Offset Brake Drum

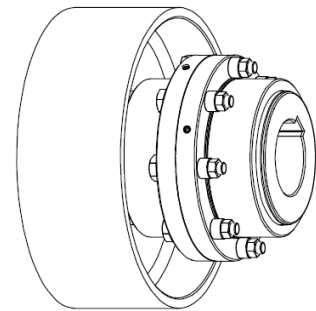
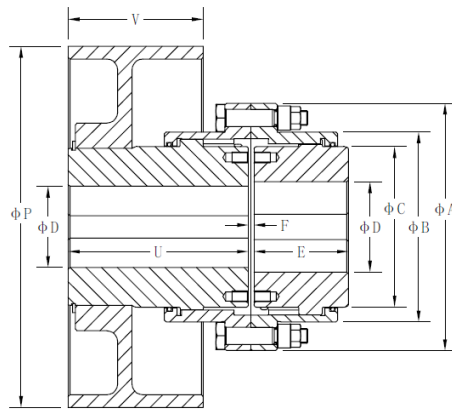

Size	TN Nm (1)	TP Nm	n Max rpm(2)	A	B	C	D Max (3)	E	F	P	U	V	Weight Max Kg (4)	Weight Min Kg (5)	Inertia J Kgm2 (4)	
10	1,800	3,600	2850	111	82.5	69	52	43	3	200	105	75	11	8	0.040	
15	2,760	5,520	2850	141	104.5	85	62	50	3	250	115	75	17	13	0.060	
			2300						3		125	95	21	18	0.126	
			1800						3		315	140	118	28	24	0.296
20	5,550	11,100	2300	171	127.5	107	78	62	3	315	130	95	30	24	0.166	
			1800						3		145	118	39	32	0.359	
			1650						3		350	145	130	45	37	0.550
			1450						3		400	160	150	59	51	1.060
25	8,700	17,400	1800	210	156	133	98	76	5	315	155	118	55	42	0.460	
			1650						5		350	155	130	61	49	0.670
			1450						5		400	170	150	76	63	1.190
30	14,100	28,200	1800	234	181.5	152	112	90	5	315	155	118	66	48	0.540	
			1650						5		350	155	130	71	54	0.740
			1450						5		400	170	150	88	69	1.280
			1300						5		450	180	170	107	88	2.12

35	22,800	45,600	1450	274	210.5	178	132	105	6	400	200	150	119	88	1.590
			1300						6	450	210	170	137	105	2.42
			1150						6	500	220	190	158	126	3.76
40	34,800	69,600	1150	312	248.5	209	156	120	6	500	220	190	181	144	4.16
			1100						6	530	220	195	192	151	4.90
			1000						6	630	250	236	239	195	9.16
45	44,000	88,000	1150	337	274	234	174	135	8	500	235	190	225	172	4.96
			1100						8	530	235	195	231	179	5.69
			1000						8	630	265	236	273	216	9.85
			800						8	710	280	265	304	245	14.66

✓ From size 45 (included) the coupling is supplied by default with puller holes. If required, puller holes can also be made for smaller sizes.

✓ Setscrews can be included upon request.

✓ Adapted hub length and value F available upon request.

(1) The torque of the coupling does not include the connection transmission capacity.

(2) Maximum speed calculated according to standard brake material (EN-GJL-250) n MAX speed for balanced couplings. For higher speeds contact Feinnord.

(3) Max. allowable bore for couplings with DIN 6885/1 key. For other types of keys or connections please contact Feinnord.

(4) Weight and moment of inertia are given for minimum bore.

(5) Weight is given for maximum bore.