

With two hubs and one sleeve, the simplicity of this continuous sleeve coupling allows it to be easily adapted to a wide variety of applications. It's very compact, low in rotating mass, and has a lower initial cost than flanged types.

## SERIES ZMH I SIZE 1 - 62

### Continuous Sleeve

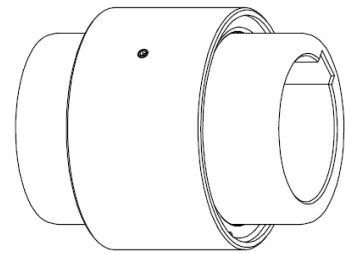
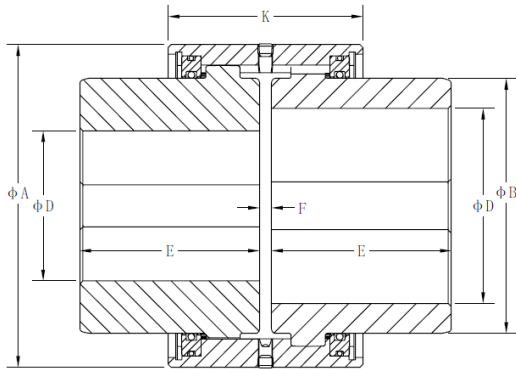

Size	TN Nm (1)	TP Nm (1)	n Max rpm(2)	A	B	K	D Max (3)	E	F	Weight Max Kg (4)	Weight Min Kg (5)	Inertia J Kgm2 (4)
1	500	1,000	12,000	56	36	47	22	30	4	0.88	0.73	0.0003
2	650	1,300	10,500	70	48	56	32	40	4	1.80	1.34	0.001
3	750	1,500	9,500	80	56	68	38	45	4	2.71	2.02	0.002
8	1,150	2,300	9,000	96	68	74	50	55	6	4.68	3.20	0.005
12	2,260	5,200	7,000	112	80	85	58	70	6	7.84	5.28	0.011
18	5,000	10,000	5,600	140	101	106	75	80	6	14.88	9.65	0.033
22	8,600	17,200	4,700	164	124	116	95	95	8	24.41	14.51	0.073
28	14,000	23,000	4,200	185	143	120	105	105	8	34.10	20.84	0.128
32	20,600	41,200	3,600	215	170	130	130	120	8	53.56	29.71	0.270
38	33,000	66,000	3,150	255	205	150	150	135	10	85.52	51.29	0.622
42	45,600	91,200	2,860	280	216	170	165	150	10	109.66	64.70	0.963
48	61,400	122,300	2,580	317	250	190	190	170	10	163.18	94.56	1.835
52	80,800	161,600	2,320	345	275	210	210	185	12	213.28	122.32	2.873
58	105,500	211,000	2,200	374	300	226	230	200	12	260.76	152.57	4.263
62	161,000	322,000	2,000	414	340	266	260	230	12	374.87	217.46	7.659

- ✓ From size 48 (included) the coupling is supplied by default with puller holes. If required, puller holes can also be made for smaller sizes.
- ✓ Setscrews can be included upon request.
- ✓ Adapted hub length and value F available upon request.

(1) The torque of the coupling does not include the connection transmission capacity.

(2) n MAX speed for balanced couplings. For higher speeds contact Feinnord.

(3) Max. allowable bore for couplings with DIN 6885/1 key. For other types of keys or connections please contact Feinnord.

(4) Weight and moment of inertia are given for minimum bore.

(5) Weight is given for maximum bore.