

Spacer couplings for pump and compressor applications simplify servicing connected equipment. Spacer couplings use a standard double engagement coupling with a spacer tube and an additional set of fasteners. Stock spacer lengths for quick delivery are available in the popular sizes. Special lengths are also available.

## SERIES ZMB I SIZE 10 - 65

with Spacer

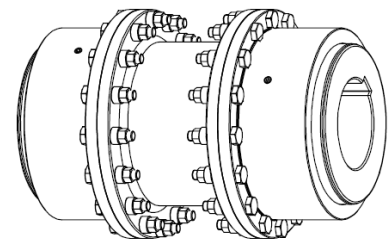
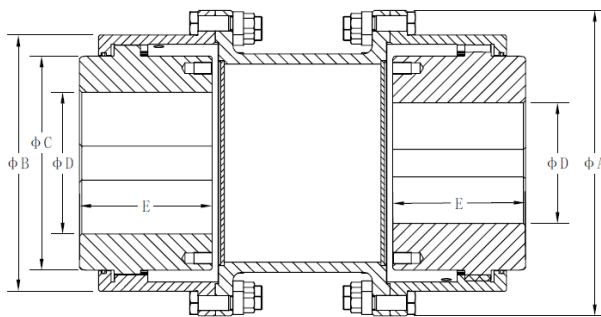

Size	TN Nm (1)	TP Nm (1)	n Max rpm(2)	A	B	C	D Max (3)	E	Weight Max Kg (4)	Weight /1000mm Spacer Kg	Weight Min Kg (5)	Inertia J Kgm2 (4)	Inertia /1000mm Spacer Kgm2
10	2,937	5,940	REFER TO CATALOG	111	82.5	69	52	43	4	0.8	3	0.005	0.0009
15	4,604	9,108		141	104.5	85	62	50	8	1.0	6	0.016	0.0019
20	9,240	18,315		171	127.5	107	78	62	14	1.5	10	0.04	0.0033
25	14,025	28,710		210	156	133	98	76	26	2.4	18	0.11	0.0096
30	23,100	46,530		234	181.5	152	112	90	39	2.7	26	0.20	0.015
35	37,950	75,240		274	210.5	178	132	105	58	3.9	42	0.45	0.025
40	57,915	114,840		312	248.5	209	156	120	91	4.7	61	0.88	0.042
45	73,260	145,200		337	274	234	174	135	115	6.6	77	1.33	0.074
50	113,025	230,340		380	308.5	254	190	150	165	10.1	115	2.48	0.17
55	139,590	276,540		405	334	279	210	175	211	8.0	142	3.59	0.14
60	249,150	501,600		444	365.5	305	233	190	250	12.2	167	5.00	0.29
65	339,075	671,550		506	424	355	275	220	411	17.2	252	10.39	0.52

✓ From size 45 (included) the coupling is supplied by default with puller holes. If required, puller holes can also be made for smaller sizes.

✓ Setscrews can be included upon request.

✓ Adapted hub length available upon request.

- (1) The torque of the coupling does not include the connection transmission capacity.
- (2) n MAX speed for balanced couplings. For higher speeds contact Feinnord.
- (3) Max. allowable bore for couplings with DIN 6885/1 key. For other types of keys or connections please contact Feinnord.
- (4) Weight and moment of inertia are given for minimum bore.
- (5) Weight is given for maximum bore.