

Shear pin couplings are used for applications subject to jamming and overload. When pins break, the equipment is physically disconnected, preventing damage. If desired shear settings are unknown, the selection should be referred to the Factory.

## SERIES ZMA I SIZE 10 - 65

with Shear Pin

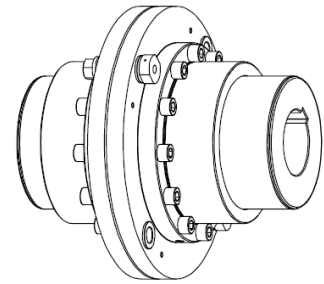
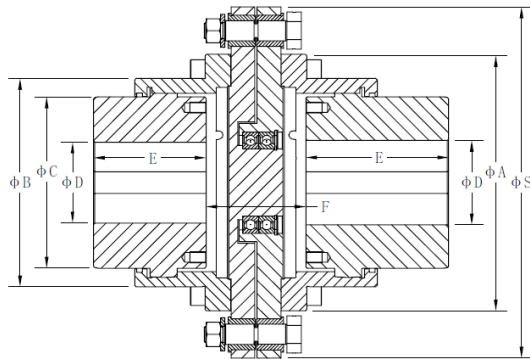

Size	TN Nm (1)	TP Nm	n Max rpm(2)	A	B	C	D Max (3)	E	F	S	Weight Max Kg (4)	Weight Min Kg (5)	Inertia J Kgm <sup>2</sup> (4)
10	1,800	3,600	8,600	111	82.5	69	52	43	39	170	10	9	0.025
15	2,760	5,520	7,000	141	104.5	85	62	50	49	220	18	16	0.075
20	5,550	11,100	5,800	171	127.5	107	78	62	61	250	27	24	0.139
25	8,700	17,400	4,700	210	156	133	98	76	55	285	43	35	0.270
30	14,100	28,200	4,200	234	181.5	152	112	90	100	335	73	63	0.700
35	22,800	45,600	3,500	274	210.5	178	132	105	105	370	106	86	1.160
40	34,800	69,600	3,200	312	248.5	209	156	120	115	410	148	119	1.960
45	44,000	88,000	2,900	337	274	234	174	135	123	435	180	145	2.69
50	69,800	139,600	2,600	380	308.5	254	190	150	166	520	282	232	6.10
55	83,800	167,600	2,400	405	334	279	210	175	170	560	340	277	8.35
60	152,000	304,000	2,200	444	365.5	305	233	190	182	590	412	318	10.74
65	205,500	407,000	2,000	506	424	355	275	220	208	660	603	443	78.83

✓ From size 45 (included) the coupling is supplied by default with puller holes. If required, puller holes can also be made for smaller sizes.

✓ Setscrews can be included upon request.

✓ Adapted hub length and value F available upon request..

- (1) The torque of the coupling does not include the connection transmission capacity.
- (2) Maximum speed calculated according to standard brake material (EN-GJL-250) n MAX speed for balanced couplings. For higher speeds contact Feinnord.
- (3) Max. allowable bore for couplings with DIN 6885/1 key. For other types of keys or connections please contact Feinnord.
- (4) Weight and moment of inertia are given for minimum bore.
- (5) Weight is given for maximum bore.