

SERIES SSS6 I SIZE 92 - 510

with Shrink Disc

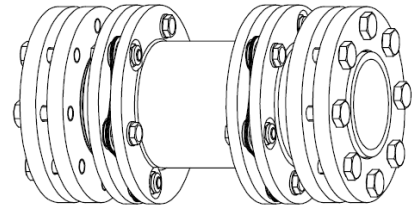
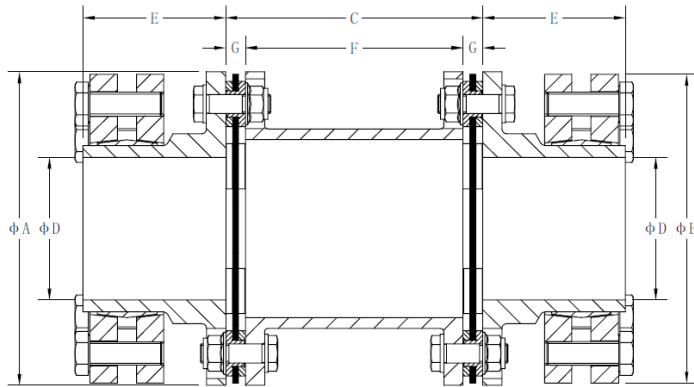

Size	TN Nm (1)	TP Nm	N Max rpm unbalanced (2)	A	B	C (3)	D Min (4)	D Max (5)	E	F	G	Inertia J Kgm2 (6)	Weight Kg (6)	Axial Misalign. ±ΔKa mm (7)	Angle Misalign ±ΔKw Degree (7)
92	240	480	11600	90	90	60	25	42	40	45	7.5	0.004	3.2	1.5	1.5
112	575	1,150	9500	110	110	88	36	52	50	71	8.4	0.010	5.7	2.1	
135	1,100	2,200	7900	132	145	108	46	70	60	91	8.4	0.028	9.6	2.6	
160	2,000	4,000	6600	158	155	124	60	75	70	102	11.2	0.053	15	3.1	
186	3,300	6,600	5600	185	185	140	66	85	80	112	14.0	0.130	26	3.7	
205	4,600	9,200	5150	202	185	158	75	105	90	127	15.5	0.170	30	3.8	1
230	7,000	14,000	4550	228	220	174	85	125	100	139	17.5	0.310	39	4.2	
256	10,200	20,400	4100	255	245	196	95	140	115	155	19.5	0.530	55	4.7	
280	14,200	28,400	3750	278	260	218	105	145	125	176	21.2	0.810	74	5.2	
305	20,000	40,000	3450	302	295	234	115	165	135	185	24.4	1.33	97	5.7	
326	25,000	50,000	3200	325	315	254	123	175	145	202	26.0	1.92	123	6.5	
346	31,000	62,000	3000	345	315	270	134	175	155	214	28.2	2.32	142	6.9	
382	42,300	84,600	2700	380	370	296	144	215	170	232	32.0	4.39	198	7.6	
412	57,100	114,200	2500	410	370	320	157	215	185	254	33.2	5.52	235	8.2	
445	73,500	147,000	2350	440	395	334	167	235	195	261	36.4	7.61	280	8.8	
480	92,000	184,000	2200	475	425	358	180	250	210	282	38.2	11.19	356	9.5	

510	117,000	234,000	2050	505	460	394	196	270	230	310	42.0	16.22	450	10.1	
-----	---------	---------	------	-----	-----	-----	-----	-----	-----	-----	------	-------	-----	------	--

Larger sizes are available on demand.

1) Nominal Torque shrink disc connection included

2) Operating speed must be equal or less than permissible speed. For higher rotation speeds, please consult Feinnord.

Permissible speeds could be limited by the weight and critical speeds of spacers. Check the dynamic balancing guide in catalog.

3) Dimension DBSE is the distance between shafts ends and is a variable parameter.

4) Shafts must be machined with tolerance g6. For other tolerances consult Feinnord.

5) The minimum bore is given for Nominal Torque. Smaller bores are possible but transmitted torque is decreased. consult Feinnord.

6) Value of complete coupling and shrink discs with std. DBSE, d1 and d2 max., GD2=4J.

7) The value for axial misalignment is given for a complete 2 disc pack. Angular misalignment is given per pack. Refer to catalog for combined permissible misalignment.