

# SERIES SRM8 I SIZE 280 - 545

## Reduced Moment

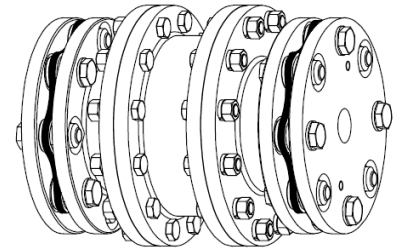
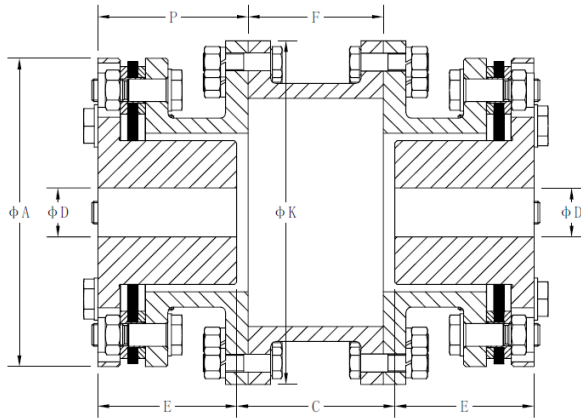

Size	TN Nm	TP Nm	N Max rpm unbalanced (1)	N Max rpm balanced (2)	A	C (3)	D Max (4)	E	F	K	P	Inertia J Kgm2 (5)	Weight Kg (5)	Axial Misalign. $\pm\Delta Ka$ mm (6)	Angle Misalign. $\pm\Delta Kw$ Degree (6)
280	20,000	40000	2800	7000	278	225	100	125	175	279	150	1.02	91	3.7	0.5
305	30000	60000	2560	6400	302	225	110	135	175	318	160	1.64	118	4.0	
326	37000	74000	2400	6000	325	215	115	145	175	346	165	2.23	134	4.3	
346	46000	92000	2200	5500	345	280	125	155	220	389	185	4.00	196	4.6	
382	63000	126000	2040	5100	380	280	140	170	220	425	200	5.92	245	5.0	
412	86000	172000	1880	4700	410	210	150	185	180	457	200	6.87	254	5.4	
545	220000	440000	1440	3600	540	190	195	240	200	527	235	21.13	508	7.2	

Larger sizes are available on demand.

- 1) Operating speed must be equal or less than permissible speed. Permissible speeds could be limited by the weight and critical speeds of spacers. Check the dynamic balancing guide and critical speeds in catalog.
- 2) Max. rotation speeds considered in special mat. and/or execution. For higher rotation speeds, please consult Feinnord.
- 3) Dimension DBSE is the distance between shaft ends and is a variable parameter.

4) The maximum bores shown are for cylindrical or taper shaft with keys. For other type of connections consult Feinnord.

5) Value of complete coupling with DBSE min, d1 and d2 max., GD2 =4J.

6) The value for axial misalignment is given for a complete 2 disc pack. Angular misalignment is given per pack. Refer to catalog for combined permissible misalignment.

Overload bushings (SRM8XXXR) are available on demand.