

**FEINORD**

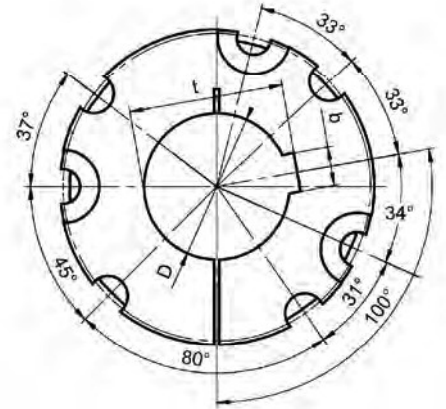
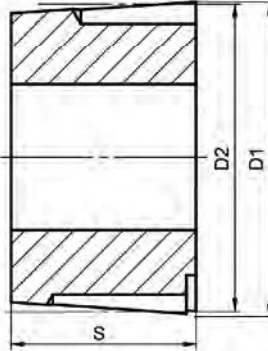

**7060**

Cast iron:GG25

Screw Specification:1-1/4-7BSW×3-1/2

Transmissible torque: 47015Nm

Bore In Metric

Screws Quantity: 4

Screw tightening torque: 880Nm

Product Code	Product Model	D1	D2	S	D (G7)	b	Js9	t	Weight (Kg)
CP018653	7060-100MM	260.4	254	152.4	100	28	±0.026	D+6.4	45.82
CP018655	7060-110MM				110	28		D+6.4	44.2
CP018656	7060-120MM				120	32	±0.031	D+7.4	42.51
CP079367	7060-127MM				127	32		D+7.4	40.57
CP080733	7060-130MM				130	32		D+7.4	38.8
CP018657	7060-140MM				140	36		D+8.4	38
CP029535	7060-160MM				160	40		D+9.4	32
CP074669	7060-165MM				165	40		D+9.4	31.1
CP074670	7060-175MM				175	45		D+10.4	27.26
CP018658	7060-180MM				180	45		D+10.4	26.68

Bore In Inches

Product Code	Product Model	D1	D2	S	D (G7)	b	t	Weight (Kg)
CP058168	7060-4-15/16	10.252"	10"	6"	4-15/16"	1 1/4"	D+7/16"	36.91
CP074671	7060-7				7"	1 3/4"	D+5/8"	23.21